

RIF6

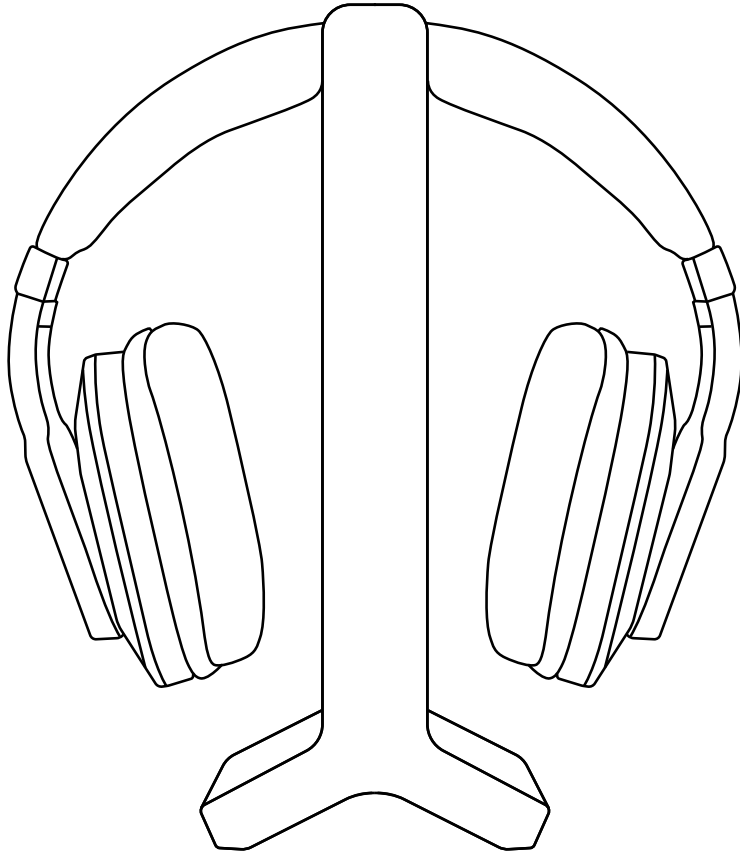

V4 DIGITAL WIRELESS
HEADPHONES

USER MANUAL

INTRODUCTION

The 2.4GHz Digital Wireless Headphones use the latest digital wireless technology to enable you to enjoy crystal clear sound from your music player or television. Simply connect the transmitter to the desired audio source: DVD player, TV set, Hi-Fi system, MP3 player, iPod, or smartphone. The system enables you to enjoy thrilling, life-like sound in minutes.

WHAT'S IN THE BOX

- Charging Base / Transmitter
- Headphones
- RCA cable
- 3.55mm Direct Line-In Cable
- AC / DC adapter
- 3.5mm Stereo Plug
- 2 AAA NiMH Batteries

FEATURES

- 2.4GHz Digital UHF Technology
- 31-Channel Frequency Hopping System
- Electronic Volume Control
- Low Power Indicator Alert
- Top Charge Mechanism
- Auto On/Off (when without signal)
- Muting
- Speed charging mechanism
- Direct Audio Line-In

COMPONENT PART LIST

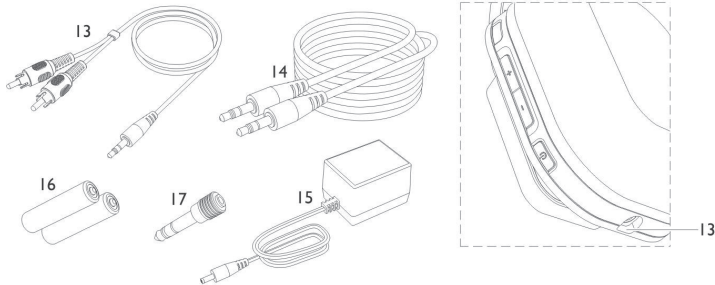
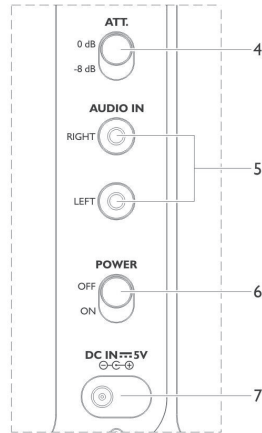
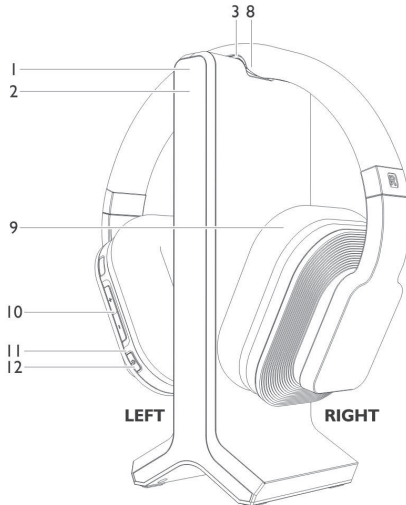

TRANSMITTER:

- 1) Charge LED Indicator
- 2) Power LED Indicator
- 3) Charging pins
- 4) Attenuation select switch
- 5) RCA Audio In socket
- 6) Power on/off switch
- 7) DC IN socket

HEADPHONE RECEIVER:

- 8) Charging contacts
- 9) Battery Compartment (inside Right Hand Side of the Ear Pad)
- 10) Volume Control
- 11) Power/Signal LED Indicator
- 12) Power ON/OFF
- 13) Direct Line-In Jack

ACCESSORIES:

- 13) RCA cable
- 14) 3.5mm - 3.5mm Direct Line-In Cable
- 15) AC/DC adapter
- 16) NiMH AAA size batteries for Headphone
- 17) 3.5mm - 6.3mm stereo plug

INSTALLATION

INSTALL THE BATTERIES

- 1) Rotate the right ear pad until it detaches from the headphones.
- 2) Insert the two included batteries, ensuring proper polarity.
- 3) Align the ear pad and rotate it back into place.
- 4) Please use only included proprietary batteries. They are made to not have to be replaced, but if yours appear to be dying, please contact customer support.

Important: Please charge your headphones for at least 6 hours before first use. Do so by turning the headphones OFF, pressing the power button and holding for a couple seconds. Place the set on the transmitter. The charging process will begin immediately, signified by the LED light glowing green. When the charge is complete, the light will shut off.

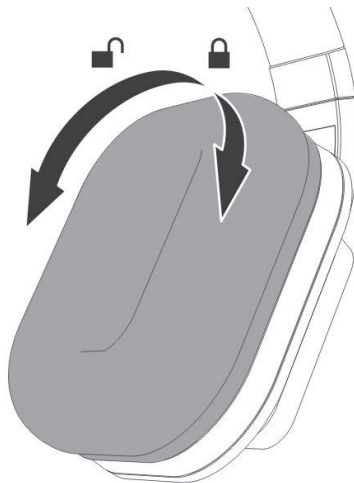

SET UP THE TRANSMITTER

- 1) Plug the AC / DC power adapter into the DC jack at the rear of the transmitter, then plug the other end of the adapter into a wall outlet.
- 2) Locate the right and left sockets for audio in at the rear of the transmitter and securely connect the RCA cable to those ports.
- 3) Connect the opposite end to the audio output jack of your TV, computer, smartphone, etc.
- 4) There is a switch at the rear of the transmitter with labels “0dB” and “-8dB”. For TV / DVD / Hi-Fi, switch to “-8dB”. For portable devices, switch to “0dB”.

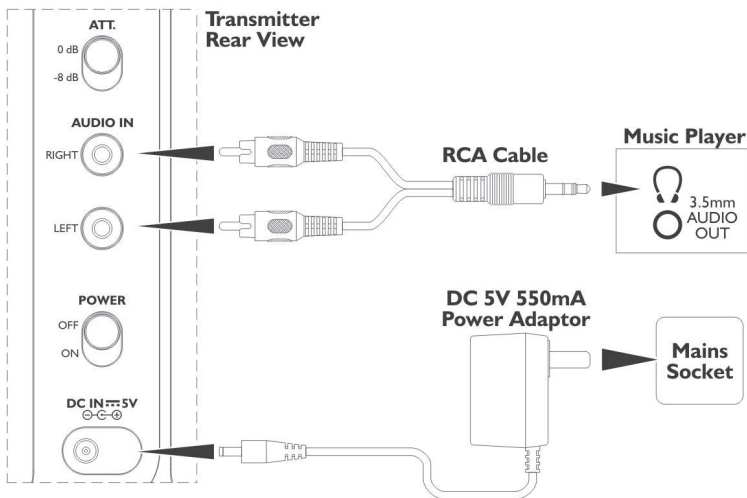

CONNECTING TO A TV / CABLE BOX / DVD PLAYER

- 1) Position the ATT switch to "0dB".
- 2) Determine what plugs you are working with.
- 3) If your device has analog audio output (red and white plugs for audio out), you'll need a Male to Male RCA cable, which is not included. Connect it to the transmitter and the audio out on the device. You can find a 6 ft 2 RCA Plug M/M Cable on www.monoprice.com.
- 4) If your device is digital output only (Optical Audio Output, only found in newer televisions) you will need to purchase a digital to analog audio converter, which you can buy online or in stores at Best Buy.

MP3 PLAYER / PORTABLE AUDIO DEVICE:

- 1) Switch the ATT on the base to -8dB.
- 2) Connect included RCA cable to the back of the transmitter and the other end to your device.
- 3) Or, use the 3.5mm auxiliary cable plugged directly into the headphones and your device.

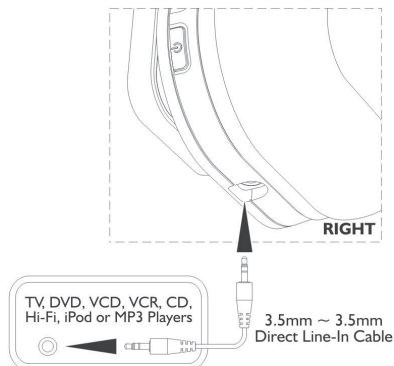

USING THE HEADPHONES

- 1) Turn on your device.
- 2) Turn on the transmitter by sliding the power switch on the rear of the device to “ON”. The Power LED light will flash blue for several seconds, then glow steadily.
- 3) Turn on the headphones by pressing and holding the power button for a couple seconds. The LED will light red, and then change to green when the audio signal has been linked between the transmitter and the headphones. If no signal is detected, it will flash red only.
- 4) Adjust the volume on the headphones to the desired level.
- 5) When you are not using the headphones, turn them off and place them on the base to charge.
- 6) If the batteries need to be charged during use, the LED will blink red and there will be a beep every minute.

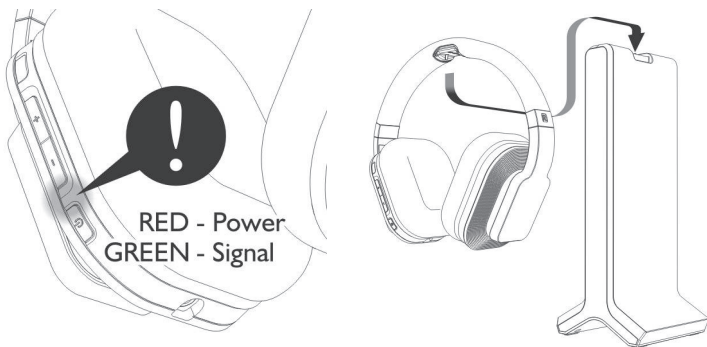

WARNING

Modification of this device to receive cellular radio-telephone service signals is prohibited under FCC rules and federal law. Changes or modifications to this unit not expressly approved by the party responsible for compliance could void the user's authority to operate equipment.

- 1) Never attempt to recharge conventional batteries.
- 2) Batteries or the headphones should not be exposed to excessive heat.
- 3) Never use batteries other than those supplied.
- 4) Prolonged exposure to excessive sound pressure may cause hearing loss.

TROUBLESHOOTING

- 1) Ensure the AC/DC adapter is fully inserted into the AC outlet and the power connection input on the transmitter.
- 2) Ensure the power button on the back of the transmitter is on and the ATT switch is properly positioned.
- 3) Ensure headphones are switched on.
- 4) Headphone battery charge levels may be too low if you are experiencing difficulty in operation, which would require a recharge.
- 5) Ensure the TV or other device is on.
- 6) You can try adjusting the volume of the headphones.
- 7) The audio signal input level may be too low, and you can increase the volume from the audio source.

DISTORTION

- Ensure the volume level of headphone is set to an approximate level.
- The headphone is too far from the transmitter, move it closer.
- The audio signal input level is too low. Increase the volume of the audio source.

TECHNICAL SPECIFICATIONS

Transmission Mode:	UHF Stereo
Carrier Frequency:	2.4GHz Digital
Operation Voltage:	Transmitter, DC 5V 550mA Headphone, 2 x AAA size Rechargeable NiMH batteries (included)
Frequency Response:	30Hz - 20KHz
Distortion:	0.5%
S/N Ratio:	70 dB
Operation Distance:	Up to 30 meters

RIF6